

- Maximum door weight 34kg
- Cable system for synchronized slide operation
- Maximum door height 2300mm
- Not suitable for flat mounting
- Temperature -20°C to +70°C
- DB - 96 hours salt spray test

20,000

- Peso máximo de la puerta 34kg
- Sistema de cableado para operación sincronizada de guías
- Altura de puerta máxima 2300mm
- No adecuada para montaje horizontal
- Temperatura de -20C hasta +70C
- DB - 96 horas de exposición en el ensayo de niebla salina

- Peso massimo anta 34kg
- Sistema cavi per funzionamento sincronizzato guide
- Altezza massimo anta 2300mm
- Non adatta per montaggio in piano
- Temperatura da -20 a +70
- DB - test a 96 ore in nebbia salina

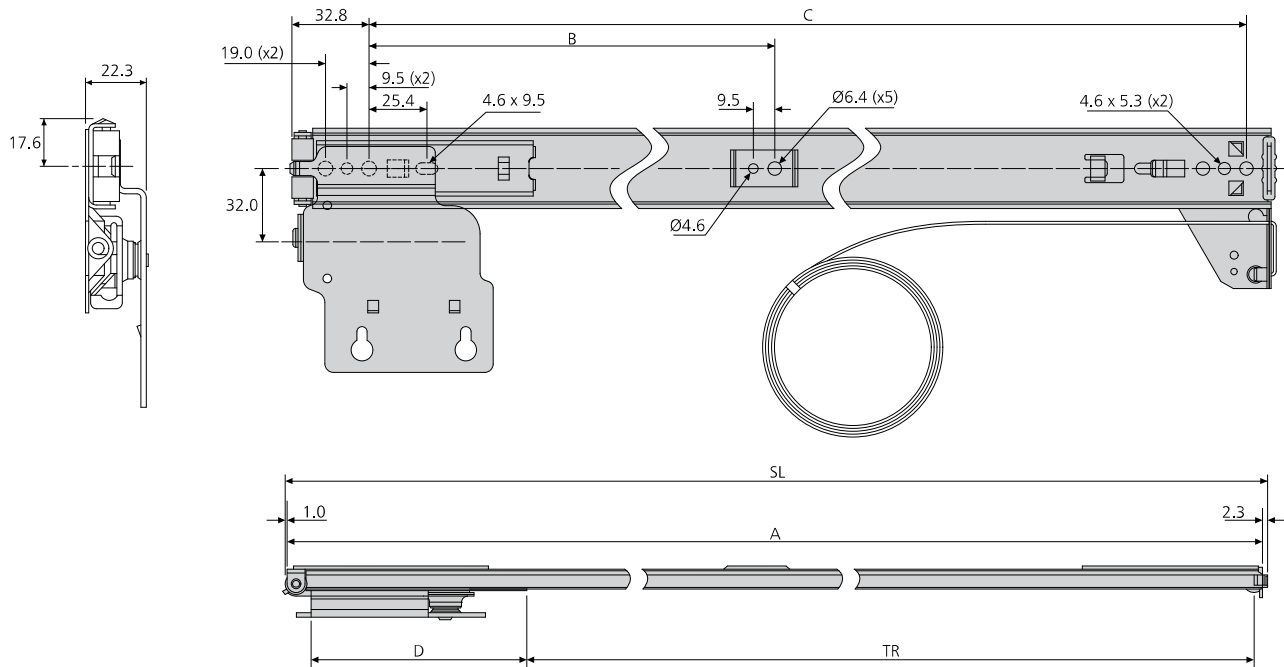
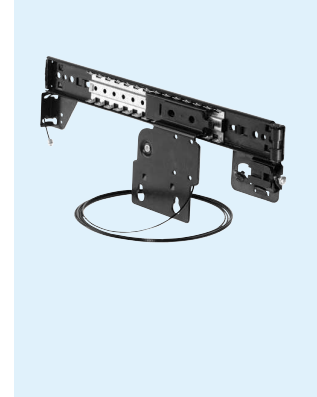

1432	mm						kg
	SL	TR	A	B	C	D	W
DB1432-0030-2	303	210	299.9	-	256.5	77.7	0.92
DB1432-0035-2	354	261	350.7	-	307.3	77.7	1.00
DB1432-0040-2	405	312	401.5	-	358.1	77.7	1.06
DB1432-0045-2	456	343	452.3	177.5	408.9	96.8	1.14
DB1432-0050-2	506	394	503.1	202.9	459.7	96.8	1.20
DB1432-0055-2	557	445	553.9	228.3	510.5	96.8	1.28
DB1432-0060-2	608	496	604.7	253.7	561.3	96.8	1.33
DB1432-0065-2	659	546	655.5	279.1	612.1	96.8	1.41
DB1432-0070-2	710	597	706.3	304.5	662.9	96.8	1.43

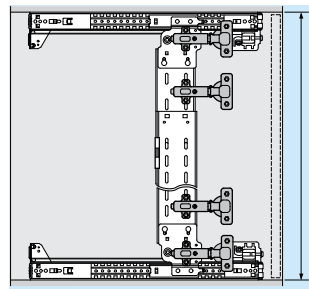

E	
915mm-1193mm	x3
1194mm-1498mm	x4
1499mm-1803mm	x5
1804mm-2300mm	x6

Optional kit ordering codes:

81020590 – hinge carrier strip kit comprises:

- 2 x hinge carrier strips, black
- 3 x connector clips, stainless steel
- assembly hardware

Order 2 x 81020590 for 2 doors 915-1422mm tall

Order 3 x 81020590 for 2 doors 1423-2000mm tall

Order 4 x 81020590 for 2 doors 2001-2300mm tall

Códigos de pedido de kits opcionales

81020590 – El kit de cintas de soporte de la bisagra comprende:

- 2 x cintas de soporte de la bisagra, negras
- 3 x pinzas de conexión, acero inoxidable
- accesorios de montaje

Pedir 2 x 81020590 para 2 puertas 915-1422mm de altura

Pedir 3 x 81020590 para 2 puertas 1423-2000mm de altura

Pedir 4 x 81020590 para 2 puertas 2001-2300mm de altura

Codici d'ordine kit opzionale

81020590 – Il kit listello portacerniere comprende:

- 2 x listelli portacerniere, neri
- 3 x clip di collegamento, acciaio inossidabile
- componenti per l'assemblaggio

Ordinare 2 x 81020590 per 2 porte 915-1422mm (alt.)

Ordinare 3 x 81020590 per 2 porte 1423-2000mm (alt.)

Ordinare 4 x 81020590 per 2 porte 2001-2300mm (alt.)

Hinge kits:

81020690 – 35mm hinge kit for inset doors 19.0-20.6mm comprises:

- 2 x 35mm Salice black clip-on hinge
- 2 x 3mm mounting base plate
- 2 x 3mm hinge base spacer
- Assembly hardware and Accuride logo cap

81020790 – 40mm hinge kit for partial overlay doors 19.0mm maximum comprises:

- 2 x 40mm Salice Zinc clip-on hinge
- 2 x 0mm mounting base plate
- 2 x 3mm hinge base spacer
- Assembly hardware and Accuride logo cap

81020890 – 40mm hinge kit for thick inset doors 20.6-31.8mm comprises:

- 2 x 40mm Salice Zinc clip-on hinge
- 2 x 3mm mounting base plate
- 2 x 3mm hinge base spacer
- Assembly hardware and Accuride logo cap

Kits de bisagras:

81020690 – El kit de bisagras de 35mm para puertas remitidas 19,0-20,6mm comprende:

- 2 x bisagra de mordaza negra Salice de 35mm
- 2 x placa de asiento de montaje de 3mm
- 2 x espaciador de base de bisagra de 3mm
- Accesorios de montaje y tapa con el logotipo de Accuride

81020790 – El kit de bisagras de 40mm para puertas solapadas de 19,0mm máximo comprende:

- 2 x bisagra de mordaza de zinc Salice de 40mm
- 2 x placa de asiento de montaje de 0mm
- 2 x espaciador de base de bisagra de 3mm
- Accesorios de montaje y tapa con el logotipo de Accuride

81020890 – El kit de bisagras de 40mm para puertas remitidas gruesas de 20,6-31,8mm comprende:

- 2 x bisagra de mordaza de zinc Salice de 40mm
- 2 x placa de asiento de montaje de 3mm
- 2 x espaciador de base de bisagra de 3mm
- Accesorios de montaje y tapa con el logotipo de Accuride

Kit cerniere:

81020690 – Il kit cerniera da 35mm per porte inserite da 19,0mm-20,6mm comprende:

- 2 x cerniera nera Salice da 35mm a clip
- 2 x piastra base di montaggio da 3mm
- 2 x distanziale base cerniera da 3mm
- Elementi di assemblaggio e cappuccio con logo Accuride

81020790 – Il kit cerniera da 40mm per porte a sovrapposizione da 19,0mm massimo comprende:

- 2 x cerniera Salice in zinco da 40mm a clip
- 2 x Piastra base di montaggio da 0mm
- 2 x distanziale base cerniera da 3mm
- Elementi di assemblaggio e cappuccio con logo Accuride

81020890 – Il kit cerniera da 40mm per porte spesse inserite da 20,6-31,8mm comprende:

- 2 x cerniera Salice in zinco da 40mm a clip
- 2 x piastra base di montaggio da 3mm
- 2 x distanziale base cerniera da 3mm
- Elementi di assemblaggio e cappuccio con logo Accuride

Notes:

- Wood thickness should be 19-32mm
- Door widths 255-660mm, door heights 915-2300mm
- Vertical mounting only
- Hinges ordered separately
- Hinge carrier strip kit ordered separately
- Please refer to 2D CAD drawings for dimensional tolerances

Notas:

- El espesor de la madera debería ser de 19-32mm
- Anchuras de las puertas 255-660mm, alturas de las puertas 915-2300mm
- Montaje vertical exclusivamente
- Las bisagras se piden por separado
- Kit de cintas de soporte de la bisagra pedido por separado
- Por favor, miren el dibujo 2D para las tolerancias dimensionales

Note:

- Lo spessore dell'anta dovrebbe essere entro 19-32mm
- Larghezza porta 255-660mm, altezza porta 915-2300mm
- Solo montaggio verticale
- Cerniere da ordinare separatamente
- Per le tolleranze dimensionali si prega di fare riferimento ai disegni 2D CAD

Hinge recommendations

Bisagras recomendadas para las guías de puertas correderas giratorias
Cerniere consigliate per le guide per ante rientranti

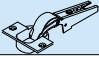
1	1234		E	F	A (mm)	B (mm)	C (mm)
	BLUM	35mm	175H9160	71T9550	16.0-19.0	6.0	1.0±2.0
	SALICE	35mm	BAR3R39	C2ABG99	19.0 20.6	8.0 9.5	0.7
	SALICE	40mm	BAR3R09	CFA7P99	19.0-31.8	14.0	0.7
	GRASS	35mm	F058139747	F028138521	19.0-25.0	6.0	1=-/2.0

2	1234		E	F	A (mm)	B (mm)	C (mm)
	SALICE	40mm	BAR3R09	CFA7G99	16.0-20.6	15.0	11.3

1	1312		E	F	A (mm)	B (mm)	C (mm)
	BLUM	35mm	173L6100 175H7100 173H7100	71T9550	16.0-19.0	7.0	1.0±2.0
	SALICE	35mm	BAR3R09	C2ABA99	19.0-22.0	8.0	1.0±2.0
	GRASS	35mm	F058139720	F028138519	16.0-24.0	7.0	1=-/2.0

1	1316/1319		E	F	A (mm)	B (mm)	C (mm)
	BLUM	35mm	175H7100 175H7100	75T1550 91M2550	16.0-20.0 16.0-20.0	6.0 6.0	4.0±2.0 4.0±2.0
	SALICE	35mm	BAR3R39	C2ABA99	16.0-20.0	6.5	1.0
	GRASS	35mm	F058139746	F028138519	16.0-20.0	6.0	3.0±2.0

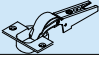
1	1432		E	F	A (mm)	B (mm)	C (mm)
	BLUM	35mm	173L6100 175H7100 173H7100	71T9550	19.0-22.0	7.0	4.3±2.0
	SALICE	35mm	BAR3R39	C2ABA99 C2ABG99	19.0 20.6	8.0 9.0	2.3 1.8
	SALICE	40mm	BAR3R39	CFA7G99	19.0-31.8	15.0	2.3
	GRASS	35mm	F058139746	F028138520	19.0-32.0mm	7.0	1=-/2.0

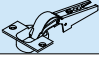
2	1432		E	F	A (mm)	B (mm)	C (mm)
	SALICE	40mm	BAR3P09	CFA7A99	19.0	15.0	11.7

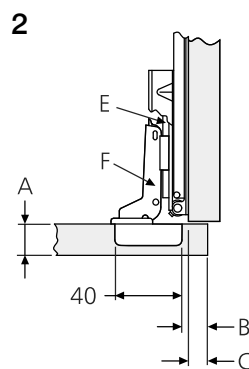
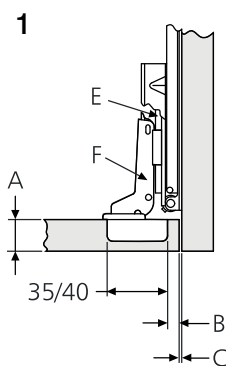

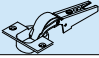

Hinge recommendations

Bisagras recomendadas para las guías de puertas correderas giratorias
Cerniere consigliate per le guide per ante rientranti

1	1234		E	F	A (mm)	B (mm)	C (mm)
	BLUM	35mm	175H9160	71T9550	16.0-19.0	6.0	1.0±2.0
	SALICE	35mm	BAR3R39	C2ABG99	19.0 20.6	8.0 9.5	0.7
	SALICE	40mm	BAR3R09	CFA7P99	19.0-31.8	14.0	0.7
	GRASS	35mm	F058139747	F028138521	19.0-25.0	6.0	1=/-2.0

2	1234		E	F	A (mm)	B (mm)	C (mm)
	SALICE	40mm	BAR3R09	CFA7G99	16.0-20.6	15.0	11.3

1	1312		E	F	A (mm)	B (mm)	C (mm)
	BLUM	35mm	173L6100 175H7100 173H7100	71T9550	16.0-19.0	7.0	1.0±2.0
	SALICE	35mm	BAR3R09	C2ABA99	19.0-22.0	8.0	1.0±2.0
	GRASS	35mm	F058139720	F028138519	16.0-24.0	7.0	1=/-2.0

1	1316/1319		E	F	A (mm)	B (mm)	C (mm)
	BLUM	35mm	175H7100 175H7100	75T1550 91M2550	16.0-20.0 16.0-20.0	6.0 6.0	4.0±2.0 4.0±2.0
	SALICE	35mm	BAR3R39	C2ABA99	16.0-20.0	6.5	1.0
	GRASS	35mm	F058139746	F028138519	16.0-20.0	6.0	3.0±2.0

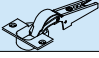
1	1432		E	F	A (mm)	B (mm)	C (mm)
	BLUM	35mm	173L6100 175H7100 173H7100	71T9550	19.0-22.0	7.0	4.3±2.0
	SALICE	35mm	BAR3R39	C2ABA99 C2ABG99	19.0 20.6	8.0 9.0	2.3 1.8
	SALICE	40mm	BAR3R39	CFA7G99	19.0-31.8	15.0	2.3
	GRASS	35mm	F058139746	F028138520	19.0-32.0mm	7.0	1=/-2.0

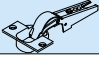
2	1432		E	F	A (mm)	B (mm)	C (mm)
	SALICE	40mm	BAR3P09	CFA7A99	19.0	15.0	11.7

