

- Maximum door weight 14kg
- Installs in 3 easy steps
- Vertical or horizontal use
- Temperature -20°C to +70°C
- DB - 96 hours salt spray test

80,000

- Poids de porte maximum 14kg
- Installation en 3 étapes faciles
- Utilisation verticale ou horizontale
- Température d'utilisation de -20 °C à +70 °C
- DB - 96 heures de tenue au brouillard salin

- Maximales Türgewicht 14kg
- In 3 einfachen Schritten eingebaut
- Vertikaler oder horizontaler Einsatz
- Temperatur -20°C bis +70°C
- DB - 96 Stunden Salzsprühtest

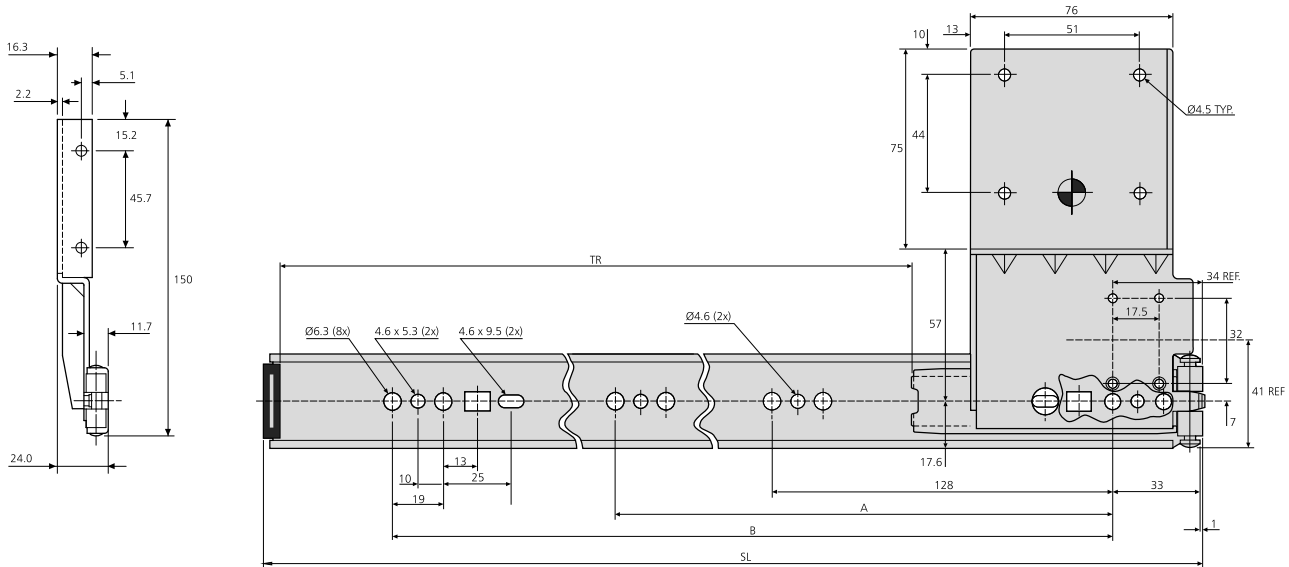
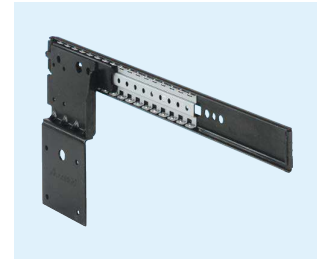

1234	mm				kg
	SL	TR	A	B	W
DB1234-0035-2	354	239	-	224	1.03
DB1234-0040-2	405	289	-	320	1.09
DB1234-0045-2	456	340	-	352	1.15
DB1234-0050-2	506	391	-	416	1.22
DB1234-0055-2	557	442	352	480	1.27
DB1234-0060-2	608	493	352	480	1.35

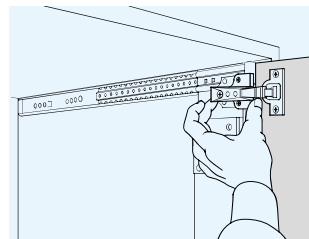
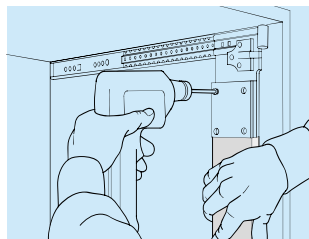
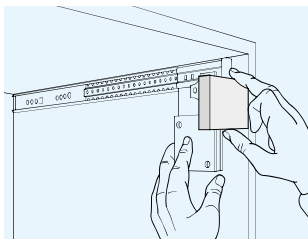

Notes:

- Doors 1100mm high x 610mm wide (maximum)
- Wood thickness should be 16-32mm
- Hinges, base plates and follower strip not supplied
- Follower strip must be used (not supplied). Oak or hard maple recommended
- Refer to "Hinge recommendations" at the end of this section
- Fixing recommendation: 4mm wood screw (supplied)/6mm Euro screw

Notes:

- Portes 1100mm haut x 610mm large (maximum)
- Épaisseur de bois préconisée: de 16 à 32mm
- Charnières, plaques d'appui et tasseaux de liaison non fournis
- Il est impératif d'utiliser un tasseau de liaison (non fourni). Chêne ou érable à sucre recommandé
- Consultez les « Recommandations concernant les charnières » à la fin de cette section
- Visserie recommandée: Vis à bois (fournies) 4mm/Eurovis 6mm

Hinweise:

- Türen 1100mm hoch x 610mm breit (max.)
- Holzstärke sollte 16mm-32mm sein
- Scharniere, Grundplatten und Traverse nicht mitgeliefert
- Traverse muss benutzt werden. Eiche oder Buche empfohlen
- ‚Empfohlene Scharniere‘ siehe Ende dieses Abschnitts
- Empfohlene Befestigung: Holzschraube 4mm (mitgeliefert)/Euro-Schraube 6mm

Hinge recommendations

Recommandations concernant les charnières

Empfohlene Scharniere

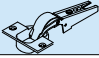
1	1234		E	F	A (mm)	B (mm)	C (mm)
	BLUM	35mm	175H9160	71T9550	16.0-19.0	6.0	1.0±2.0
	SALICE	35mm	BAR3R39	C2ABG99	19.0 20.6	8.0 9.5	0.7
	SALICE	40mm	BAR3R09	CFA7P99	19.0-31.8	14.0	0.7
	GRASS	35mm	F058139747	F028138521	19.0-25.0	6.0	1=-/2.0

2	1234		E	F	A (mm)	B (mm)	C (mm)
	SALICE	40mm	BAR3R09	CFA7G99	16.0-20.6	15.0	11.3

1	1312		E	F	A (mm)	B (mm)	C (mm)
	BLUM	35mm	173L6100 175H7100 173H7100	71T9550	16.0-19.0	7.0	1.0±2.0
	SALICE	35mm	BAR3R09	C2ABA99	19.0-22.0	8.0	1.0±2.0
	GRASS	35mm	F058139720	F028138519	16.0-24.0	7.0	1=-/2.0

1	1316/1319		E	F	A (mm)	B (mm)	C (mm)
	BLUM	35mm	175H7100 175H7100	75T1550 91M2550	16.0-20.0 16.0-20.0	6.0 6.0	4.0±2.0 4.0±2.0
	SALICE	35mm	BAR3R39	C2ABA99	16.0-20.0	6.5	1.0
	GRASS	35mm	F058139746	F028138519	16.0-20.0	6.0	3.0±2.0

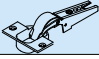
1	1432		E	F	A (mm)	B (mm)	C (mm)
	BLUM	35mm	173L6100 175H7100 173H7100	71T9550	19.0-22.0	7.0	4.3±2.0
	SALICE	35mm	BAR3R39	C2ABA99 C2ABG99	19.0 20.6	8.0 9.0	2.3 1.8
	SALICE	40mm	BAR3R39	CFA7G99	19.0-31.8	15.0	2.3
	GRASS	35mm	F058139746	F028138520	19.0-32.0mm	7.0	1=-/2.0

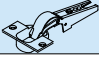
2	1432		E	F	A (mm)	B (mm)	C (mm)
	SALICE	40mm	BAR3P09	CFA7A99	19.0	15.0	11.7

